

The Cresset Gallery Suite First Floor

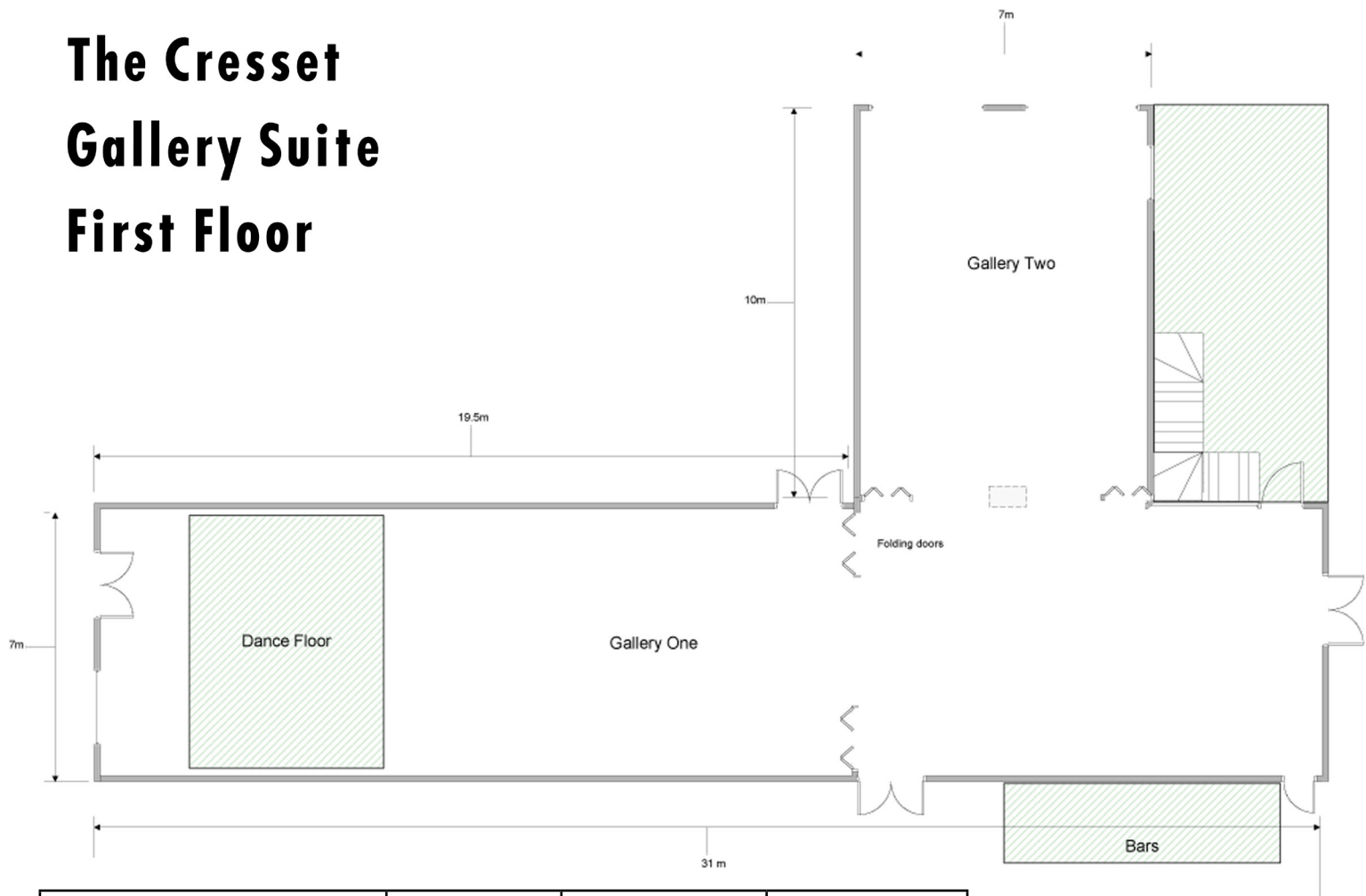

Room Capacity by layout	Gallery 1	Gallery 2	Combined Suite
Theatre Style	150	60	180
Boardroom	40	25	40
Classroom 2 per table	40	18	56
U-Shape with tables	30	25	30
Horseshoe Chairs	45	32	45
Round tables (full room) 8 per table	96	48	160
Round tables (with dancefloor) 8 per table	72	48	136
Cabaret style rounds 6 per table	54	30	84
Casual Seating	80	50	150

- Disabled access
- Natural Daylight
- Air Conditioning
- AV Equipment
- Private bar